

**IMPORTANT:**

**Manufacturer is not responsible for negligent use of vehicle with mud flaps installed, including over-tightening of screws and bolts causing damage to vehicle or mud flaps.**

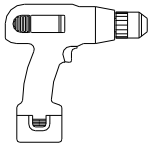

**TOOLS REQUIRED-**



Electric or Rechargeable  
Drill



1/4" Drill  
Bit

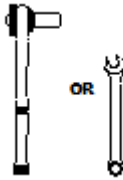

5/16" Open Wrench or  
Socket Wrench

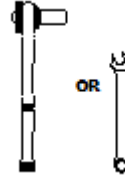

1/4" Open Wrench or  
Socket Wrench

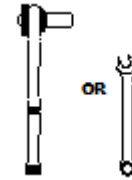

3/8" Open Wrench or  
Socket Wrench

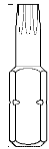

T15 Torx  
Bit

**FLAPS**

(1) Flap Assembly,  
Front, DS  
Part #766687

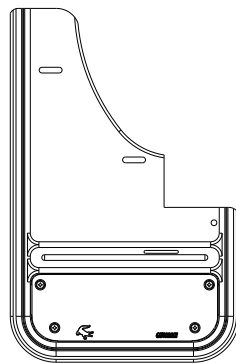

(1) Flap Assembly  
Front, PS  
Part #766688

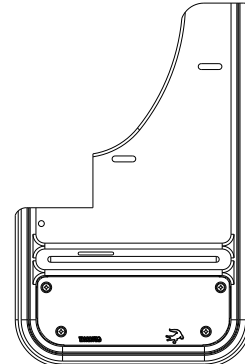

**PARTS BAG # 766692**

a) (4) Washer, Flat  
0.203" x 1.5", 18GA, SS  
Part #018066

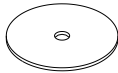

b) (8) Washer, Flat, SS  
0.203" ID x 1" OD, 18ga  
Part #018031



c) (4) Washer, Lock  
18-8SS, Helicoil  
Part #024001



d) (4) Screw, Mach.  
18-8SS, 10-24x1, Hex Hd  
Part # 012022



e) (4) Nut, Hex  
#10-24, SS  
Part # 025003



f) (4) Bolt, Hex Flange, SS  
M 4.2 x 1", Black  
Part #016041

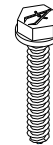

g) (2) "L" Clip  
Front  
Part #766691

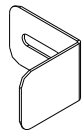

**INSTALLATION** (For ease of installation it is suggested that the wheel be removed)

1. Before you install your Mud Flap Set, see the diagram and parts list for all necessary parts. Start on the driver's side.
2. Remove the 2 factory screws in the wheel well and 1 factory push pin from the bottom of fender.
3. Install mud flap to fender through holes #1 and #2 into holes #5 and #6 using a stainless steel bolt (#016041) and a stainless steel washer (#018066). Loosely secure at this point.
4. Install "L" bracket through hole #3.



- Using a bubble level or square, ensure that the mud flap is level. Viewing the vehicle from the back, the outer edge of the mud flap should appear parallel to the tires. Tighten fasteners on holes #1 and #2.
- Secure “L” bracket to fender through hole #7 using one machine screw (#012022), two stainless steel washers (#018031), one lock washer (#024001), and one hex nut (#025003).
- Drill a 1/4” hole through mud flap hole #4 into liner (#8).
- Secure flap through hole #4 into fender hole #8 using one machine screw (#012022), two stainless steel washers (#018031), one lock washer (#024001), and one hex nut (#025003).
- Carefully tighten all fasteners and ensure that the mud flap has remained level.
- Repeat procedure for the passenger side.

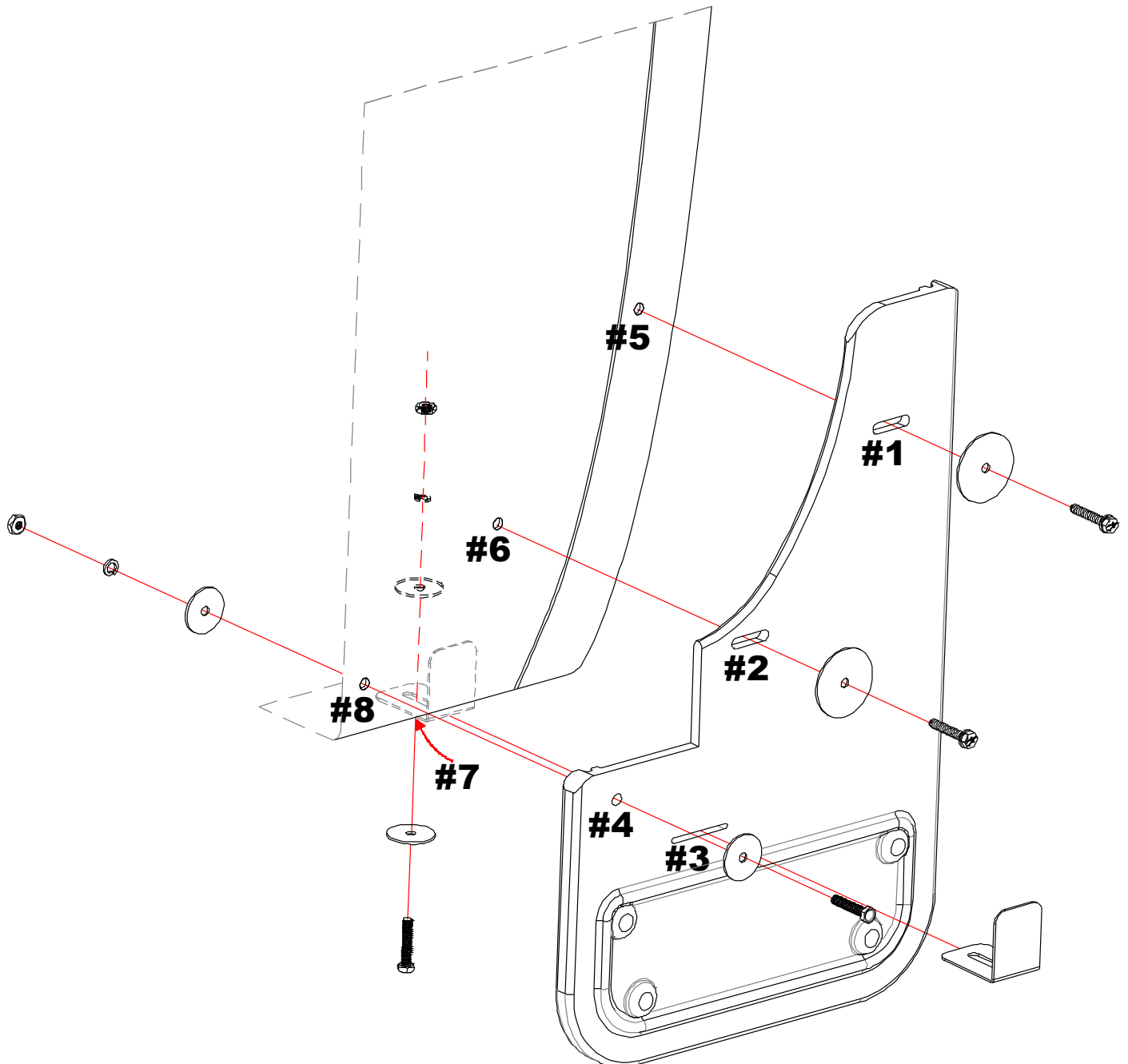

Please check out our YouTube channel to see an install video for this application.



**IMPORTANT:**

*Manufacturer is not responsible for negligent use of vehicle with mud flaps installed, including over-tightening of screws and bolts causing damage to vehicle or mud flaps.*



**TOOLS REQUIRED-**

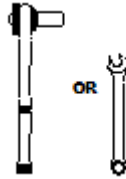

5/16" Open Wrench or  
Socket Wrench

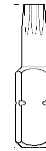

T15 Torx  
Bit

**FLAPS**

(1) Flap Assembly,  
Front, DS  
Part #766696

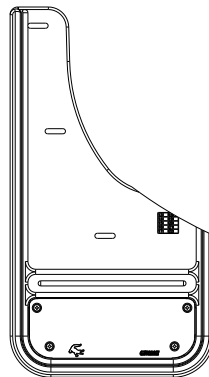

(1) Flap Assembly  
Front, PS  
Part #766697

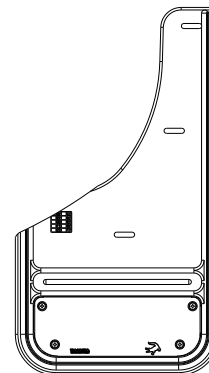

**PARTS BAG # 766698**

a) (6) Washer, Flat  
0.203" x 1.5", 18GA, SS  
Part #018066

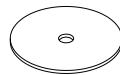

f) (3) Bolt, Carriage, SS  
1/4"-20x1.5"  
Part #016041



**INSTALLATION** (For ease of installation it is suggested that the wheel be removed)

1. Before you install your Mud Flap Set, see the diagram and parts list for all necessary parts. Start on the driver's side.
2. Remove the 3 factory screws from the fender.
3. Starting on the bottom hole, install the mud flap to fender through holes #1 to #3 into holes #4 to #6 using a stainless steel bolt (#014016) and a stainless steel washer (#018066). Loosely secure at this point.
4. Using a bubble level or square, ensure that the mud flap is level. Viewing the vehicle from the back, the outer edge of the mud flap should appear parallel to the tires.



- Carefully tighten all fasteners and ensure that the mud flap has remained level.
- Repeat procedure for the passenger side.

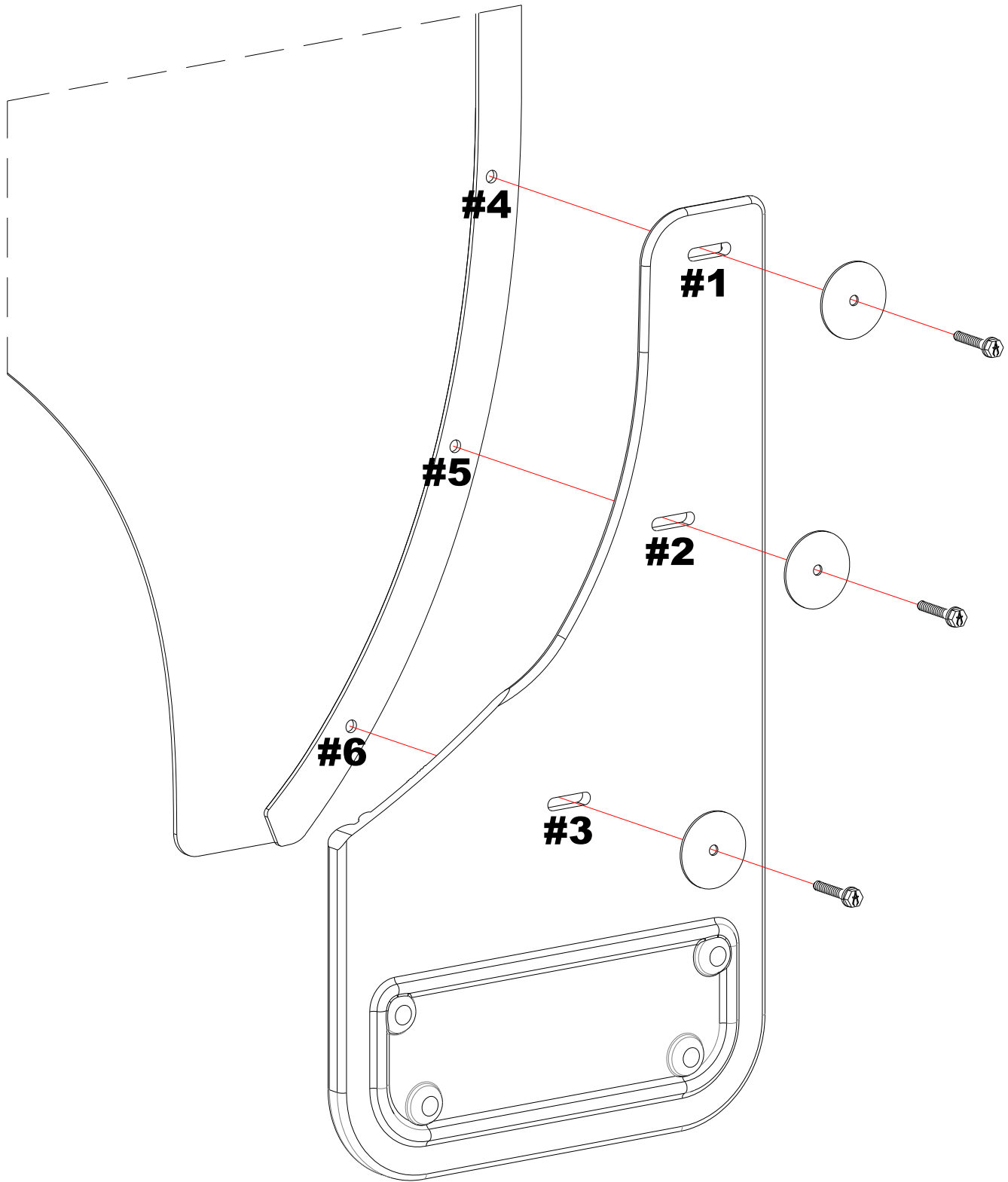

Please check out our YouTube channel to see an install video for this application.

